

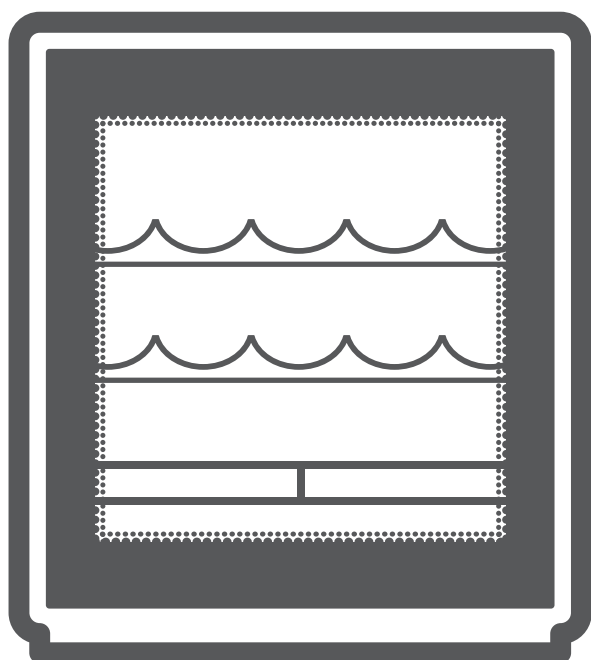

# WINE COOLER

- USER'S MANUAL



**MODEL:**

IW14BL  
IW14BL-BS  
IW16BL  
IW16BL-BS



# TABLE OF CONTENTS

1. SAFETY & WARNING INSTRUCTIONS.....	4
2. ELECTRICAL INFORMATION .....	5
3. SOCIABLE REMARKS - ENVIRONMENTAL PROTECTION.....	5
4. STEPS BEFORE USE .....	6
5. GETTING TO KNOW YOUR WINE COOLER.....	7
6. WINE COOLER FEATURES .....	8
7. INSTALLATION GUIDELINES.....	9
8. TEMPERATURE SETTING & ZONES .....	12
9. MAINTENANCE & CLEANING .....	13
10. STORAGE.....	14
11. TIPS.....	14
12. TROUBLESHOOTING .....	15

Dear Consumer,

Congratulations on your choice!

Inventor's Wine Coolers create ideal conditions for perfect wine maturity within the bottle, enhancing 100% the quality of your favorite drinks. Low energy consumption and a modern design, is an ideal combination, making Inventor Wine Coolers the best choice!

Please refer to this manual of the Wine Cooler, through the guidelines included, to benefit from both, energy savings and performance efficiency.

# 1. SAFETY & WARNING INSTRUCTIONS

- No children under the age of 8 should be permitted to operate this electric device. Be certain, that children, handicapped people, or people with the lack of knowledge and experience, must be supervised, depending the situation, by persons responsible for their well-being and do not undertake procedures such as the cleaning or the maintenance of this device.
- It is important that adequate supervision is provided and no minors are left unattended with this device.
- This device is intended to be used in household and similar residential applications such as:
  - 1) Farmhouses; staff kitchen areas in shops, offices and other working environments;
  - 2) By clients in hotels, motels bed and breakfast and other residential type environments.
- This household product is intended for the storage of wine only. Do not use this device to store blood, drugs, biological products or other items.
- Do not install the appliance in areas that are too humid or too cold, such as construction appendices, garages or wine cellars.
- This device should always be kept in an upright position to avoid any damage.
- If the supply cord is damaged, it must be replaced by the manufacturer, its service agent or similarly qualified persons to avoid a hazard. Never attempt to dismantle, repair or modify the device.
- Ventilation openings, in both the appliance's enclosure and in the built-in structure should be clear of obstructions. Mechanical devices or other means of accelerated defrosting should not be used, only methods recommended from the manufacturer should be applied.
- As this device is heavy, always be cautious when relocating, safety gloves are recommended.
- When relocating this appliance, slightly lift from the front, in order to avoid any floor damage.
- Do not attempt to repair, dismantle or modify this appliance. Contact your authorized service technician for repair or maintenance of this device.
- Do not operate this unit by switching the main power supply on or off.
- During operation, do not touch the compressor or the condenser, be cautious as they are hot.
- The manufacturers of this product prohibit the placement of regulators, power adaptors, or any other appliances on top of the wine cooler. This appliance is not intended for use in the food pantry.
- Do not place heavy objects on the power cord. Make sure that the cord is not compressed.
- Do not place cord under any obstacles (carpets rugs or runners etc). Cord should be arranged away from areas where accidental tripping may occur.
- Do not operate other electric appliances inside the food storage compartments of this device, unless recommended by the manufacturer.
- Do not store explosive substances such as aerosol cans with a flammable propellant in this appliance.
- The refrigerant circuit should remain intact. If damage occurs, be extremely cautious of any flames or sources of ignition. Ventilate the room.
- Do not sit or climb on the device.
- To avoid any possible injury, be cautious of your fingers, while closing the unit's door. Gentle door closing, helps prevent accidental misplacement of the items inside.
- Removing items from the Wine Cooler with wet hands should be avoided, as it is highly possible for a frostbite to occur.
- Do not place the unit in direct sunlight or near other heating sources like radiators, cookers, ovens or hobs.
- Do not use the unit near heat sources, chemicals, radiators, flammable materials or fire.

- Upon first use, and for proper calibration, please allow unit to operate continuously for 24 hours.

## 2. ELECTRICAL INFORMATION

- The nameplate, with all the electrical and technical data of this appliance, is located on the rear panel.
- The appliance should be installed in accordance with national wiring regulations.
- Be sure the device is grounded properly. Proper grounding is important as it minimizes the chance of electric shock or fire. The power cord is equipped with a grounding plug for protection against electric shock hazards.
- The device must be used in a properly grounded wall socket. If the specific socket you intend to use is not adequately grounded or protected by a time delay fuse or circuit breaker, have a qualified electrician install the proper receptacle.
  - A 10A plug outlet or higher, should only be used.
  - This Wine Cooler requires 220-240V/50Hz AC power, possible voltage fluctuations over 220-240V±10% may cause the malfunction and damage of the unit.
- Ensure the wall socket is still accessible after the installation of the Wine Cooler.
- Do not use extension cords or adapter plugs with this device.
- Be certain that no damage has occurred to any of the electrical components (e.g. main plug, main cable, compressor). If any damage has occurred, please Contact certified Service or a qualified electrician.
- To avoid personal injury, always disconnect the power supply of the device, before maintenance.



**Power off the refrigerator before removing the plug. Do not disconnect the plug from the wall socket by pulling on the cord.**

## 3. SOCIABLE REMARKS - ENVIRONMENTAL PROTECTION

Disposal of equipment no longer used:

Please follow the instructions below, when using this refrigerator in European countries.

- This appliance requires special treatment for disposal. In the European Union, electronic equipment must not be treated as domestic waste, but must be disposed of professionally in accordance with Directive 2002/96/EC of the European Parliament and Council of 27th January 2003 concerning old electrical and electronic equipment. The disposal of this unit should follow all legal requirements and should not be disposed as unsorted municipal waste.

The hazardous substances can leak into the ground water supply thus entering the food chain, endangering your health and the environment.

- There are several alternative solutions for disposal. Please remove all doors before disposal to prevent children's accidental trapping.



A) Your local municipality has established free collection systems for electronic waste.

B) Your local retailer upon purchase of a new product.

C) The manufacturer may accept the old appliance for disposal.

D) Old appliances sometimes contain valuable resources for scrap metal dealers.

## 4. STEPS BEFORE USE

User's manual

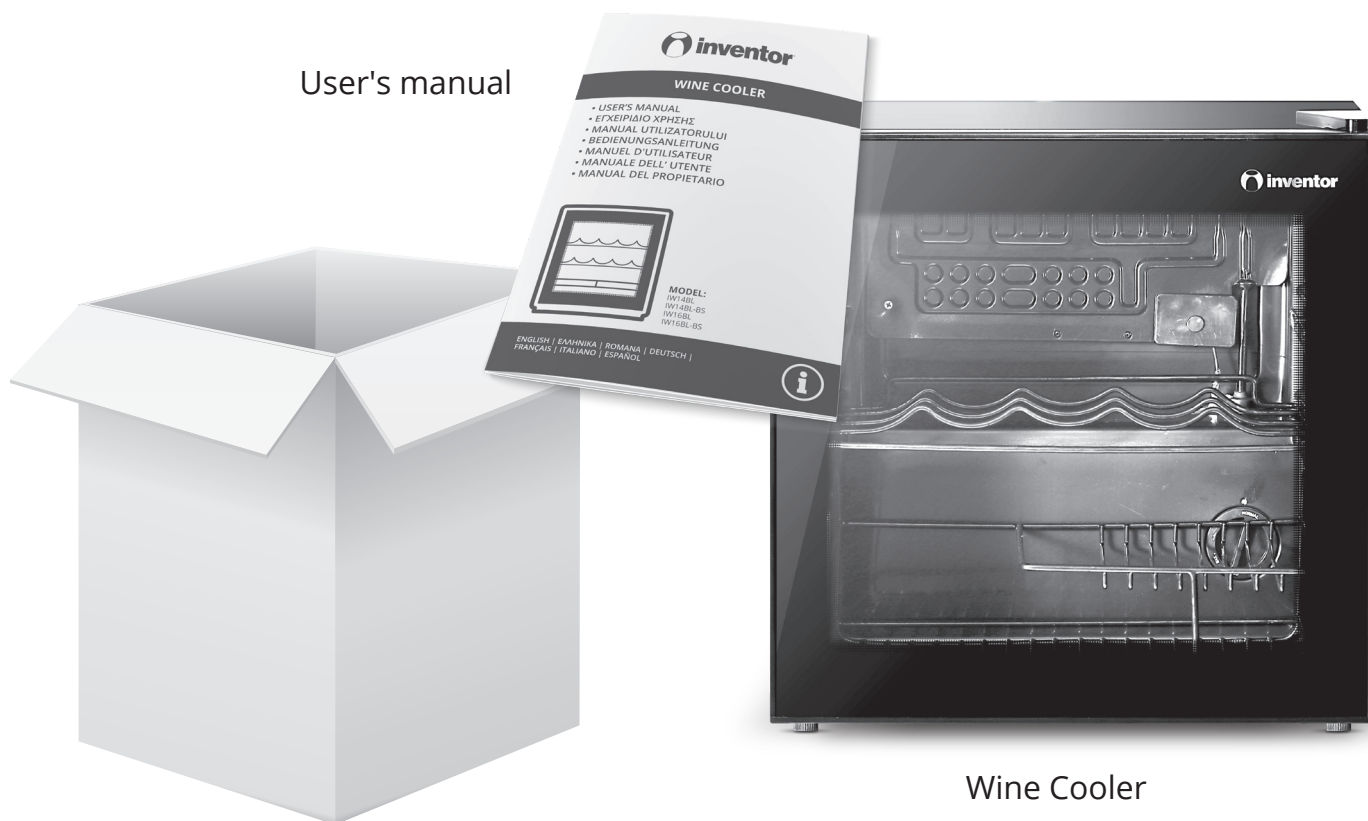

Wine Cooler

Please refer to the electronic warranty instructions, in the last page (English section) of this manual.

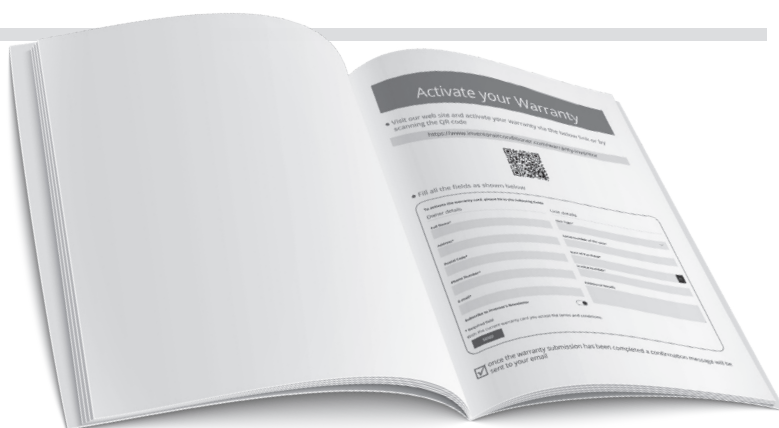

For warranty purposes, please note the SN (serial number). The SN is labeled behind the device.





## 5. GETTING TO KNOW YOUR WINE COOLER

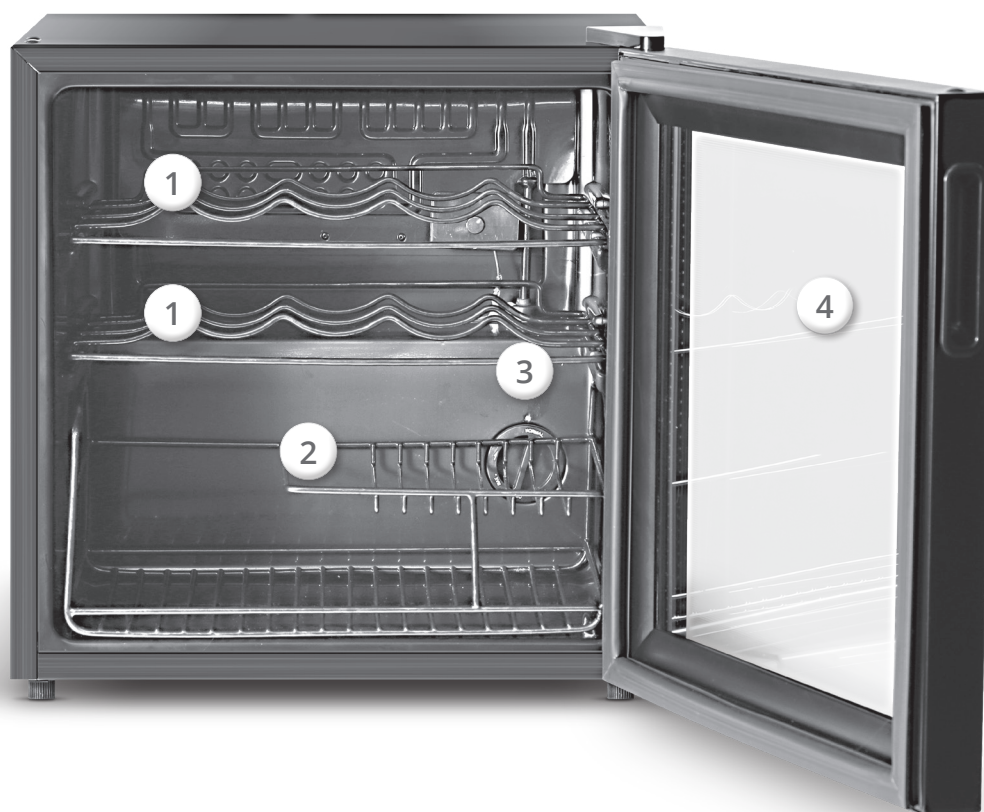

**1. Wine Racks 2. Wine Basket 3. Thermostat 4. UV glass door**  
**5. Reversible Door 6. Adjustable Feet 7. Power Cord**



## 6. WINE COOLER FEATURES

MODEL NAME	IW14BL/ IW14BL-BS	IW16BL/ IW16BL-BS
Category	WINE COOLER	WINE COOLER
Energy Class	A+	A
Power Supply (V/Hz/Ph)	220-240/50/1	220-240/50/1
Energy Consumption (kWh/annum)	105	135
Total Storage Volume (L)	43	49
Refrigerant / Mass (g)	R600a/18	R600a/13
Climate Class	ST	N
Noise Level db(A)	42	42
Net Weight (Kg)	19	20
Dimensions (WxDxH) (mm)	480x440x492	470x450x490
Power Cord Length (mm)	1700	1700
Color	Black	Black
Number of shelves	1	2
Reversible Door	YES	YES
Built-in	NO	NO

Position the appliance in a location where the ambient temperature corresponds to the climate classification for which it is designed. You can find the climate classification on the name plate. The following table shows the climate classification and its matching ambient temperature:

SN	10 - 32°C (cold environment)
N	16 - 32°C (normal)
ST	16 - 38°C (semi-tropical)
T	16 - 43°C (tropical)

The Wine Cooler will not operate efficiently at room temperatures below 16°C. If the internal temperature of the Wine Cooler is too low, possible damage to its contents may occur. Accumulation of frost on the Wine Cooler's door, may take place if the room's temperature is 32°C or higher, or if the humidity within the area reaches a level of 72%RT.

## Interior Dimensions (mm)

\*The above prices may be subject to deviation. Kindly refer to the purchased product.

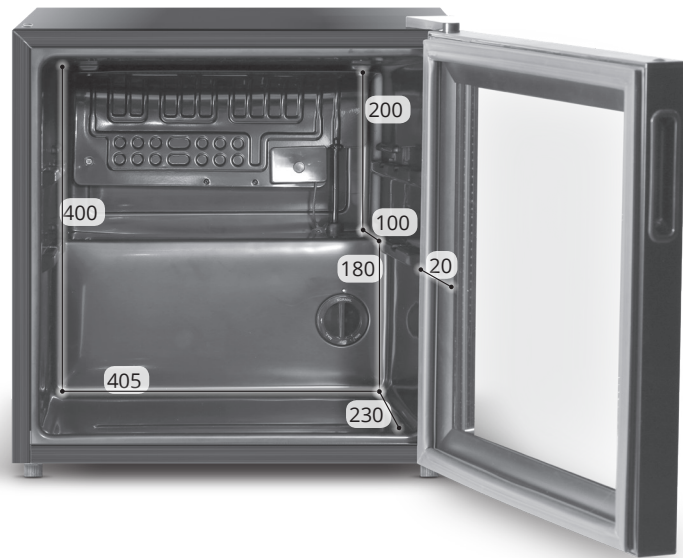

## 7. INSTALLATION GUIDELINES

### Position

Upon the positioning of this unit, keep in mind the floor must be flat and sturdy and the room should be well ventilated, without additional heating sources nearby.

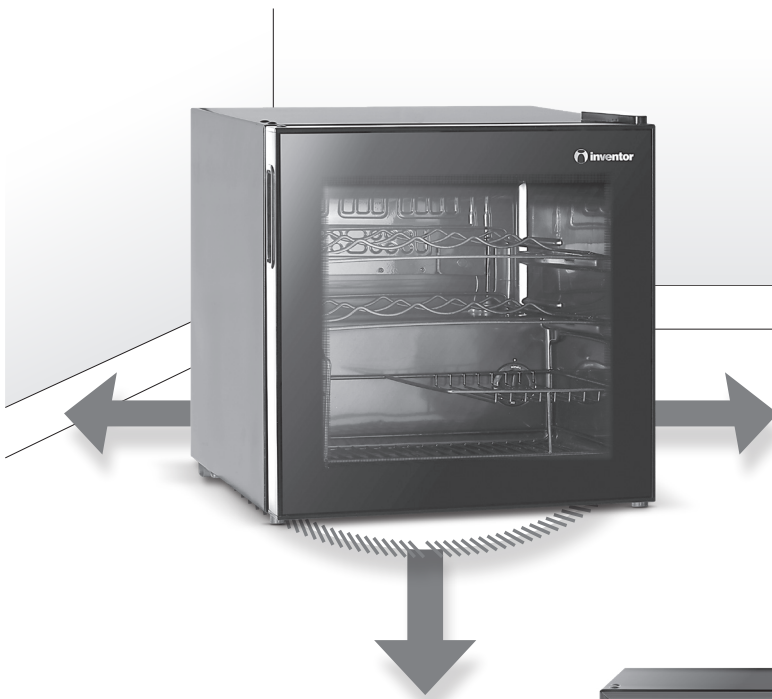

**1.** Allow sufficient air ventilation surrounding the unit. The rear end (backside) of this appliance should stand against a wall allowing sufficient air ventilation as follows:

- 20cm from the top
- 15cm from the back
- 40cm from the rest sides

**2.** Wait at least 4 hours before connecting the appliance to the power supply, thus, allowing all fluids to settle in the compressor.





## Reversible Door

The door opening can change from either the left or the right side, according to what is best suited for its location. Ensure there is enough adequate space for the door to open fully (90 degrees). To change the door opening direction, please follow the mentioned below instructions:



### Required tools:

**Head Screwdriver / Slot head Screwdriver / Hexagonal Spanner**

- Before reversing the door swing, unplug the appliance from the power supply and remove goods from fridge.



**1.** Adjust the two leveling feet to their highest position. Tilt the unit slightly backwards to take the door off. Rest the unit on something solid so that it will not slip during the door reversing process.



**Do not lay the unit flat as this may damage the coolant system.**

**2.** Remove the plastic cover located on the top right or left (depending on initial door installation side) of the door hinge, and unscrew the two screws with the stabilizing pin.



**3.** Slightly tilt so that you may have access to the front bottom bracket. Unscrew the two screws located on the bottom left or right (depending on initial door installation side) and remove the foot from the opposite side. Once top and bottom screws and also the opposite foot are removed, the door will be completely released.

**4.** Remove the three plastic caps from the side you are going to install the door, and place them on the side where the door was originally installed, in order to cover the three screw holes.



**5.** Place the door on the desired side making sure it is in its upright position. Screw the top two screws of the door hinge. Slightly tilt, for better positioning, and screw the bottom hinge into place, and also screw the removed foot on the other side. Once completed clip on the top plastic cap.

**6.** Check if door is aligned horizontally and vertically and that the door when shut is completely sealed from all sides. Finally tighten the bottom hinge and re-adjust the foot on the opposite side for correct leveling.



## Leveling the Unit

Adjust the two levelling feet at the front of the unit. If the unit is not aligned, the door and magnetic seal alignments will not be covered properly.



## 8. TEMPERATURE SETTING & ZONES

### Thermostat Temperature Setting

The thermostat is located internally, at the right hand bottom side of the Wine Cooler.

- **Setting "OFF"**: the cooling operation stops
- **Setting "MIN"**: Minimum cooling (15°C -21°C)  
Suggested when the storage quantity is minimal.
- **Setting "NORMAL"**: Normal cooling (8°C -15°C)  
Upon initial use, make sure to set the thermostat on "NORMAL" setting and allow 24hours prior to placing any items.

- **Setting "MAX"**: Maximum cooling (2°C -8°C)  
If there is a max capacity of bottles within the device, or if the outside temperature is high, the thermostat may be set to its highest position, for a short period of time.



**For correct temperature control settings, kindly consider the following:**

- ✓ Room temperature
- ✓ The frequent door opening of the Wine Cooler.
- ✓ The quantity of stored bottles
- ✓ The positioning of the appliance.

### Temperature Zones

The air circulation creates different temperature zones in the wine cooler. The upper interior level has the highest temperatures while the lower level has the lowest.

Wine bottle storage from top to bottom is advised as follows:

- Strong red wine
- Pink and mild red wine
- White wine
- Champagne and spritzer

Pour wines shall be placed a bit lower than the serving temperature. This will allow the wine to breathe and still come to the proper serving temperature.





## 9. MAINTENANCE & CLEANING

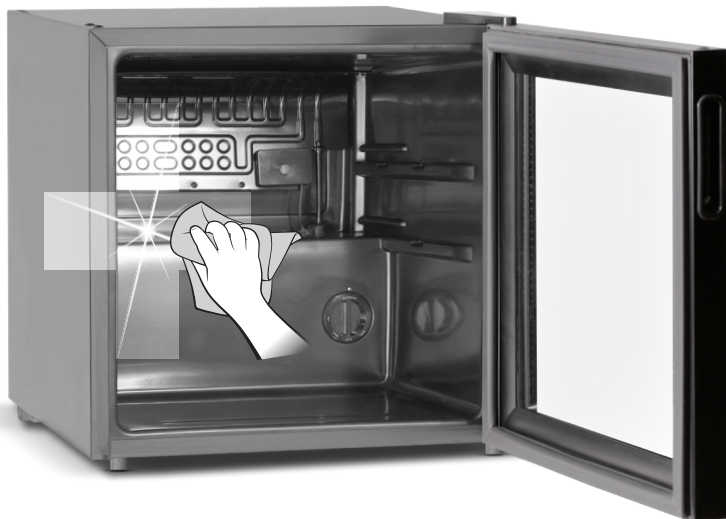

Prior to cleaning the appliance, un-plug from the wall power socket, and remove all shelves.

- Clean the appliance with a moist soft cloth. Use only neutral detergents.
- Clean the unit's interior with a weak bicarbonate soda solution and rinse with warm water applying a damp sponge or cloth.
- Use a damp cloth to clean the exterior, keep in mind the door must be shut to avoid getting any polish on the magnetic door seal or the interior of the unit.
- Make sure not to let any water spill on the control elements of the door.

- Be certain that there is no water spilling on the control elements of the door
- While cleaning, you may lightly rinse the interior with water and dry

- Allow the appliance to dry for approximately 1 to 2 hours.
- Set thermostat to NORMAL position. Plug into a power source. The appliance will chill continuously until set temperature has been reached.
- Be sure to regularly clean the drain hole to ensure proper drainage.

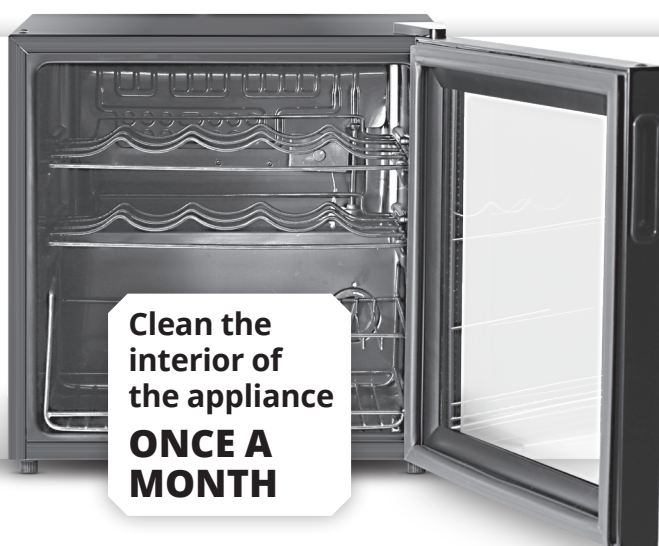

- **Do not use abrasive products, abrasive cleaning pads, solvents or metal objects. Do not use water spray and steam to clean the appliance.**
- **Do not use extreme moist cleaning pads. Any moisture around the electric components, should be avoided.**
- **The use of a steam cleaner is prohibited, as this may be very dangerous.**

## Defrosting Process

Water drops, or possible frost may be accumulated in the rear of the unit when the compressor is operating, this is normal operation. There is no need for wiping off these water drops or frost, as the defrosted water will be collected into the drain tank and then lead in the water disposal pan, located above the compressor, and will be vaporized.



- **Never use sharp or metal objects to remove frost while defrosting**
- **Do not use any mechanical devices or instruments to accelerate the defrosting process prior to consulting the manufacturer**

## 10. STORAGE

When appliance is inactive for an extended period of time, please make sure you follow the instructions below, for the appropriate storage of your appliance:

- Turn the unit off allowing one day before storage.
- Remove all the items from the interior compartment.
- Clean the removable parts of the device.
- Leave the door open to prevent unpleasant odors.
- Cover the device.
- Store the wine cooler in upright position, in a dry, well ventilated area and avoid direct sunlight.

## 11. TIPS

- ✓ Do not place products too close. Ensure a sufficient distance for optimum air circulation in the wine cooler.
- ✓ Avoid extensive use of the door on wet and hot weather. Be cautious, once the Wine Cooler's door is open to shut the soonest possible.
- ✓ Do not place goods in direct contact with the wall of the refrigerator, always allow some space.
- ✓ Be certain the wall behind the appliance is dirt and dust free, especially with outer condenser equipped units.
- ✓ Do not store boxed wine in this device.
- ✓ Avoid placing hot beverages in the wine cooler.
- ✓ Moisten the cork before replacing it into the bottle to prevent air space between the cork and the bottle.



## Serving Temperature TIPS

- ✓ Wines should be allowed adequate time to breath prior to serving. (red wine: 4-5 hours and pink wine: 2-5 hours). White wines and champagne can be served immediately.

Wine Kinds	Serving Temp
Bordeaux red	18°C
Cotes du Rhone red/Barolo Louis Family dry red wine/Barolo	17°C
Burgundy red/Bordeaux red	16°C
Port	15°C
Young Burgundy red	14°C
Young red wine	12°C
Young Boaujolais/all wines with little residual sugar	11°C
Old white wines/Chardonnay	10°C
Sherry	9°C
Young white wines from late vintage	8°C
White wines Loire/Entre-deux-Mers	7°C

## 12. TROUBLESHOOTING

ISSUE	CAUSE / REMMEDY
<b>Appliance is not working</b>	The plug is not in the power socket. Put the plug in the power socket.
<b>Temperature in refrigerator is too high or too low</b>	1) Thermostat has been set incorrectly. Set the thermostat correctly. 2) Turn power off and allow 5 minutes for temperature to be reset.
<b>Cooler isn't chilling on the lower part of the interior</b>	Frequent door openings or maximum allowable bottle storage. Keep door shut for approximately 4-5 hours, then recheck.
<b>Condensation appears on the inside surface of the unit</b>	This may be caused by a change in the room's temperature or due to high humidity levels. Use a soft cloth to wipe away any condensation. If the problem persists, contact a certified technician for assistance.
<b>Appliance is making a noise</b>	1) The refrigerant liquid causes noises in the cooling system. 2) Noise is produced while the compressor is operating, as refrigerant fluid is being pumped within the unit. 3) Make sure the refrigerator is levelled and balanced. 4) Goods have been placed incorrectly in the refrigerator. Place the goods correctly in the refrigerator. 5) Check if the refrigerator's components are in the proper position.

<b>The wine cooler's door can't be properly closed</b>	<p>Make sure items are not obstructing the door.</p> <p>Make sure the refrigerator is not overfilled.</p> <p>Make sure the refrigerator is not tilted.</p>
<b>Long term operation of the compressor</b>	<p>It is normal if the compressor runs for a long time during high ambient temperatures.</p> <p>Avoid overfilling.</p> <p>Allow warm and hot goods to chill prior to placing them in the unit.</p> <p>Avoid the frequent opening of the door.</p>

NOTE: All the pictures in the manual are for explanatory purposes only. The actual shape of the unit you purchased may be slightly different, but the operations and functions are the same.

# Activate your Warranty

- Visit our web site and activate your warranty via the below link or by scanning the QR code

<https://www.inventorappliances.com/warranty-card>



- Fill all the fields as shown below

To activate the warranty card, please fill in the following fields

Owner details	Unit details
<p>Full Name*</p> <input type="text"/>	<p>Unit Type*</p> <input type="text"/>
<p>Address*</p> <input type="text"/>	<p>Serial Number of the unit*</p> <input type="text"/>
<p>Postal Code*</p> <input type="text"/>	<p>Date of Purchase*</p> <input type="text"/>
<p>Phone Number*</p> <input type="text"/>	<p>Invoice Number*</p> <input type="text"/>
<p>E-mail*</p> <input type="text"/>	<p>Additional Details</p> <input type="text"/>
<p>Subscribe to Inventor's Newsletter <input type="checkbox"/></p>	

\* Required field

With the current warranty card you accept the terms and conditions.

SEND

- ☒ once the warranty submission has been completed a confirmation message will be sent to your email





## WINE COOLER



Scan here to download the latest version of this manual.  
Σαρώστε εδώ για να κατεβάσετε την τελευταία έκδοση του εγχειριδίου.

v07

